

# Flat

Design by Ichiro Iwasaki.

## Reference

**5924.**

## Application

Ceiling Lamps

## Installation type

Surface

## Description

Flat is a large ceiling lamp made up of horizontal discs at various heights that create planes of reflected light. The discs are self-illuminated by reflected light. The Flat ceiling light has a strong graphic quality, combining structure and functionality.

## Diffuser

Polycarbonate diffuser

## Materials

Ceiling rose: Steel  
Reflector: Aluminum  
Body: Steel  
Head: Aluminium

## Finish

**5924-10** White (NCS S 0300-N)

**5924-72** White, Green L1 (NCS S 0300-N, NCS S 4005-G80Y)

**5924-73** White, Grey L1 (NCS S 0300-N, NCS S 1000-N)

## Sketch

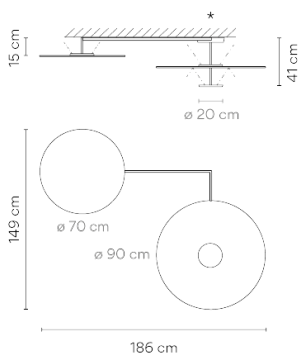

## Electrical characteristics

3 x LED PLATE 25W 700mA

Total 75.0 W



A+

# VIBIA



**Light source:** 2700K CRI >90 10440 lm 139 lm/W

**Driver included:** CC - Constant Current 700 mA 110~240V 50/60Hz

**Electronic dimming:** DALI 1-10V PUSH

**Optional dimming:** Casambi

## Physical characteristics

1 Box / 0.46 x 1.06 x 1.28 m. / Vol. 0.6216 m<sup>3</sup> /

Gross weight 26.6 kg. / Net weight 20.0 kg.

## Installation and assembly

Please, see the installation manual

## Light distribution

### Indirect lighting

Lamp that emits an upward or backward beam that is reflected by the ceiling or wall.

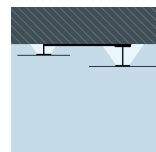

## Photometric data

Efficiency : 88.00 lm/W

Coordinate system : CG

Total flux : 7154.22 lm

Maximum value : 2122.35 cd

Light position : C=0.00 G=180.00

Symmetry on the planes : Double symmetrical

Isolux : floor

Light position :

X=0.00m Y=0.00m Z=2.50m

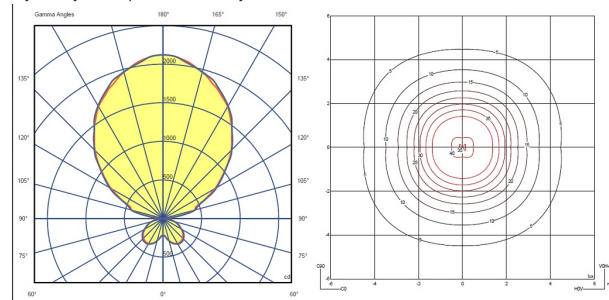

## Certificates

