

# Flat

Design by Ichiro Iwasaki.

## Reference

**5905.**

## Application

Ceiling Lamps

## Installation type

Surface

## Description

Flat is a ceiling lamp composed of horizontal discs at various heights that create planes of reflected light. The Flat ceiling light has a strong graphic quality, combining structure and functionality.

## Diffuser

Polycarbonate diffuser

## Materials

Ceiling rose: Steel  
Reflector: Aluminum  
Body: Steel  
Head: Aluminium

## Finish

 **5905-10** White (NCS S 0300-N)

 **5905-71** White, Green L1, Grey L1 (NCS S 0300-N, NCS S 4005-G80Y, NCS S 1000-N)

## Sketch

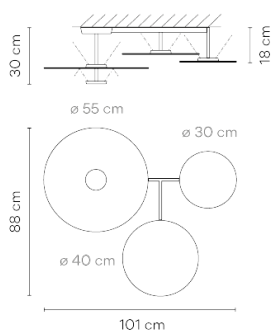

## Electrical characteristics

4 x LED PLATE 13,5W 700mA

Total 54.0 W



**Light source:** 2700K CRI >90 6960 lm 128 lm/W

**Driver included:** CC - Constant Current 700 mA 110~240V 50/60Hz

**Electronic dimming** DALI 1-10V PUSH

## Physical characteristics

1 Box / 0.32 x 0.73 x 0.73 m. / Vol. 0.1691 m<sup>3</sup> /

Gross weight 16.2 kg. / Net weight 15.4 kg.

## Installation and assembly

Please, see the installation manual

## Light distribution

### Indirect lighting

Lamp that emits an upward or backward beam that is reflected by the ceiling or wall.

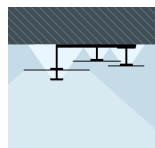

## Photometric data

Efficiency : 68.21 lm/W

Coordinate system : CG

Total flux : 3015.66 lm

Maximum value : 826.00 cd

Light position : C=0.00 G=180.00

Symmetry on the planes : Asymmetric

Isolux : floor

Light position :

X=0.00m Y=0.00m Z=2.50m

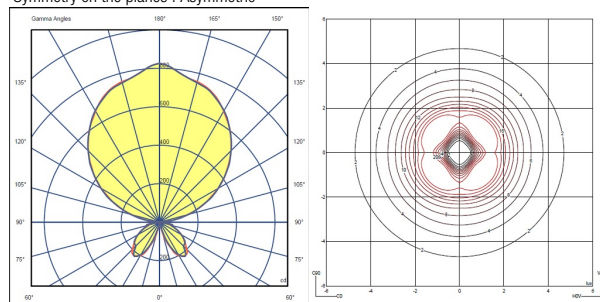

## Certificates

